



# **2017 GULFSTREAM G650 SPECIFICATIONS**











## 2017 G650 SPECIFICATIONS

Aircraft Make: Gulfstream Aerospace Corporation  
Aircraft Model: G650  
Date New in Service After Completion: 05 May 2017  
No Damage History: On MYCMP  
Registration Mark: China  
Aircraft Base Location: Beijing, China

Total Airframe Time: 1874 Flight Hours 737 Landings  
(as of September 2023)

Engine Make & Model: Rolls Royce Deutschland Ltd & Co Kg Model BR725A1-12 (G650)  
Engine Power-by-The Hour Plan: RRCC  
Engine Total Time: 1874 Hours and 1874 Hours  
Engine Cycles: 737 Cycles and 737 Cycles

Make & Model Auxiliary Power Unit: Honeywell Model RE-220 (G650)  
APU Power-By-The Hour Plan: NIL  
APU Total Time: 2060 Hours

### Highlights:

Engines Enrolled on RRCC	EIS 2017
15 Passenger Configuration	SBB High Speed Internet
Always in Hangered	One Owner Since New
Low Airframe Hours	

### Avionics:

(3) Honeywell Primus Epic FMS w/ WAAS / LPV	(3) Modular Avionics Units (MAU)
(3) Triplex NextGen Flight Management Systems	(2) Standby Multifunction Controllers (SMC)
(4) Large Flat Panel LCD Electronic Display Units	(3) Multi-Function Control Display Units (MCDU)
(2) Cursor Control Devices (CCD)	(1) Cockpit Voice Recorder (CVR) - Datalink Recording
(4) Multifunction Air Data Probes (MFP)	(3) Inertial Reference Systems (IRS) LASEREF VI
(2) 24-Channel Global Positioning Systems (GPS)	(1) Datalink VDL Mode 2
(1) Synthetic Vision - Primary Flight Display (SV-PFD)	(1) LCD Head-Up Display (HUD II)
(1) Enhanced Vision System II (EVS II)	(1) Data Loading LAN Management Unit (DLMU)
(2) High Frequency (HF) Communications	(3) Very High Frequency (VHF) Communications
(1) VHF Communication/Navigation Unit	(2) Mode S Transponders w/ Advanced Surveillance
(1) Traffic & Collision Avoidance System (TCAS 7.1)	(2) Distance Measuring Equip. (DME) Transceivers
(1) Satellite Communications System (SATCOM)	(2) Enhanced Ground Proximity Warning Sys (EGPWS)
(1) Flight Data Recorder (FDR)	(1) Automatic Emergency Descent Mode

## Interior

Features 15 Passengers + Flight Deck Crew + Observer Jump Seat Configuration with Forward Crew Lavatory and Aft Cabin VIP Lavatory. Forward Galley having a Microwave Oven, High Temperature Oven, Dual Coffee Maker, Refrigerator and Ample Storage. Forward Cabin has 4 Seats in Club Arrangement with Tables, Mid Cabin has 4-Place Dining – Conference Group opposite a 2 Seats in Club Arrangement with Table and Aft Cabin has 2 Seats in Club Arrangement opposite a dual 3-Place Divans.

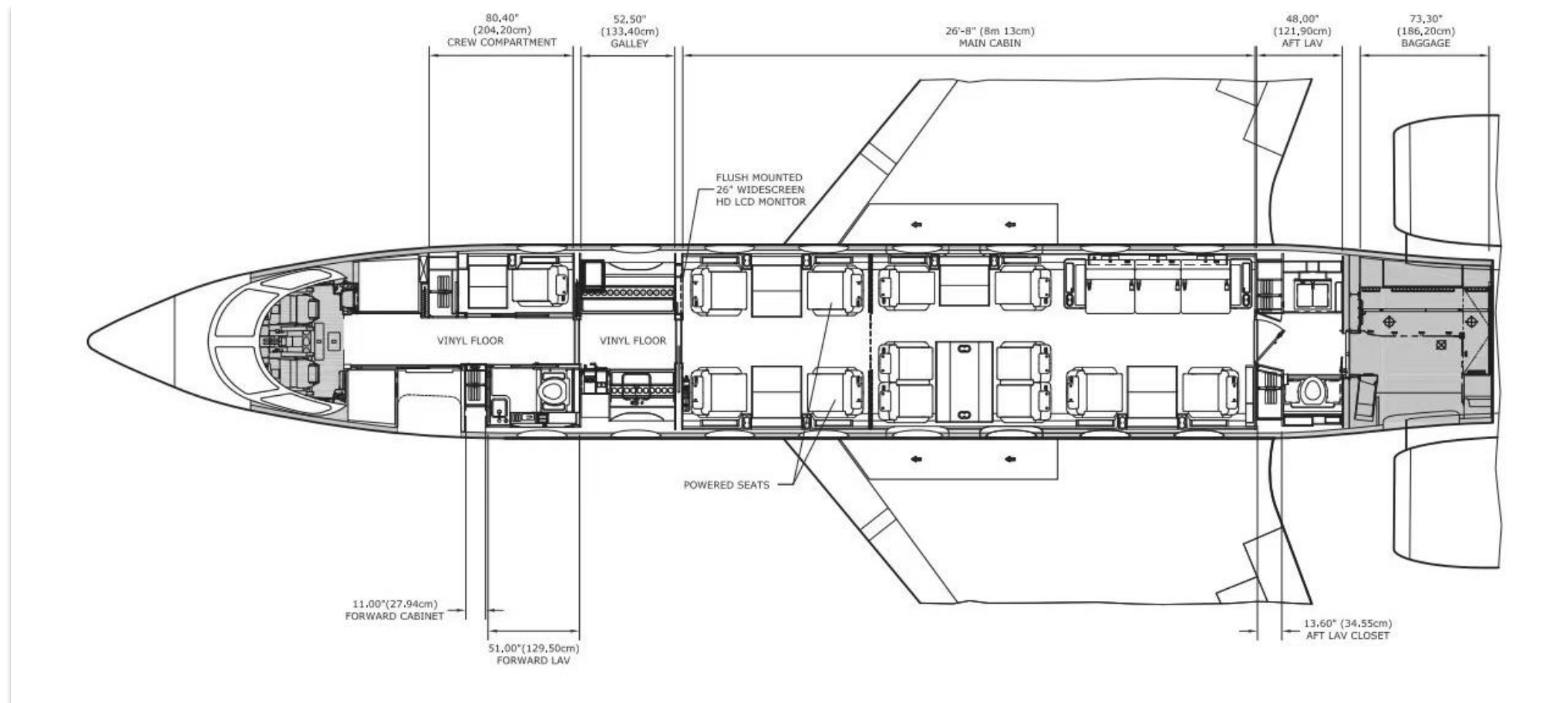

## Exterior

Overall Matterhorn White























**Aircraft specifications are subject to verification upon aircraft inspection by purchaser.  
Aircraft availability is subject to prior sale or withdrawal from the market without prior written notice.**





# *Think Tank Total Solutions Practice*

**J More Pte LTD**

ADD: WOA office #03-01, 66 Selatar Aerospace View, Singapore 797509

EMAIL: [info@jmore.club](mailto:info@jmore.club)